



Introducing **Retreat**, Maple Leaf Homes' Newest Design

With a modern cottage style, this home provides a spacious open concept floor plan with 2 bedrooms and 2 bathrooms. Large windows and patio doors offer a beautiful view to the exterior making it ideal for your waterfront property.

68' X 18'

1224 TOTAL SQ FT

Exterior:

- Shed Style Roof – 1.25/12 Slope
- R22 Wall Insulation - R50 Roof Insulation – R31 Floor Insulation
- Natural Eastern White Cedar Shingle Siding
- Kaycan Urbanix Vertical Siding in Recessed Entry – Colour Harvest Cedar
- Kohltech Bronze Front Door – Deco Glass – Full Glass Sidelight
- Kohltech Bronze Back Door with Transom – Full Glass
- Custom Kohltech Windows – Int. White & Ext. Bronze
- 9 ft. Select Series Kohltech Sliding Patio Door – Center Operator with Sliding Screen Door
- Sloped Ceiling – 10 ft. to 8 ft. Walls
- Recessed Entry with Exterior Shower and Privacy Wall

Interior:

- 84" Front Entry Bench
- DuraFusion Luxury Vinyl Tile Throughout – Colour Poplar White
- Custom Entertainment Center with Floating Shelves and Cabinets
- Horizontal White Washed Pine Board Dining Room Wall with 84" x 18" Pine Floating Bench
- Upgraded Glenwood Cabinets with High Gloss White Finish and Après Ski Wood Grain
- Quartz Countertop "Moon White" in Kitchen and Bathrooms, "Grey Mist" in Laundry
- 4"x 16" White Tiled Backsplash in Kitchen – Stacked Pattern
- Black Stainless Steel Kitchen Appliances
- Linen and Full Length Washer/Dryer Cabinets in Laundry
- Berkley Interior Doors with Sliding Hardware in Bedroom Closets – Colour White
- Lever Style Door Hardware, Canaropa "The Flat" - Chrome
- White Wash 1"x 6" Square Edge T&G Interior Pine Ceilings Throughout
- 3 ½" Berkley Interior Door Casing, 4 ½" Berkley Baseboard Trim Throughout – Colour White
- Undermount Stainless Steel Kitchen Sink and Undermount White Vanity Sinks
- Upgraded Chrome Faucet Package Throughout
- 5' x 3' MAAX White Shower Base with Erosion Bora White Utile Walls and Glass Panel in Ensuite
- 5' MAAX White Tub with 12"x 24" White Ceramic Walls, Stacked Pattern and Glass Panel in Main Bath
- Upgraded Lighting Throughout
- Built in Coffee Station
- Floating Vanities with Accent Lighting

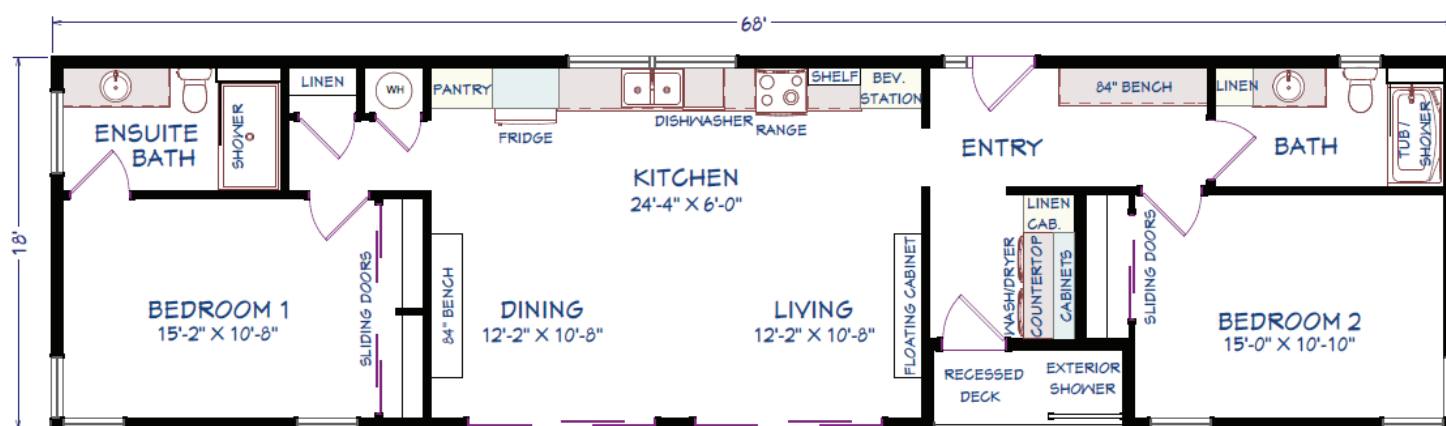

2 BEDROOMS, 2 BATHROOMS
1224 TOTAL SF

*We build **your** home, **your** way.*

Customization at its best, you have the option of choosing from our large selection of some of the best home designs in the industry. From traditional Mini-Homes to our newest Retreat design, the quality care and service of the Maple Leaf Team will exceed your expectations. Once you have chosen your design, our design consultant will assist you in customizing your new home to suit your personal style and taste. Anything from siding colour to kitchen cabinets will be tailored just for you! Start envisioning your dream home today! For more information on this or any other Maple Leaf Home, visit our website at mapleleafhomes.ca for a retailer in your area.

MAPLE LEAF  HOMES

655 WILSEY RD, FREDERICTON NB E3B 7K3 • 506.459.1335 • MAPLELEAFHOMES.CA